

1 Pictorial one

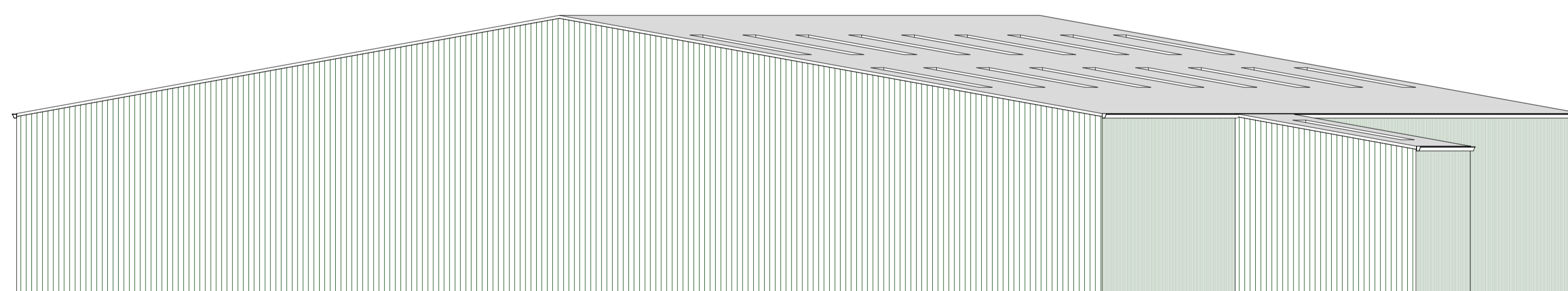

2 Pictorial two

Rev	Description	Date

CODE	SUITABILITY DESCRIPTION
STATUS	PURPOSE OF ISSUE

**Trojan Stud, Brynlluan,
Porthyrhyd, Carmarthen,
SA32 8PR**

PROJECT

Portal frame

PROPOSED CONSTRUCTION OF A PORTAL FRAME BUILDING TO COVER AN EXISTING MANAGE FOR MIXED EQUINE AND AGRICULTURAL PURPOSES.

DRAWN BY Author	CHECKED BY Checker	DATE 02/03/2019
SCALE (@ A1)		PROJECT NUMBER Project Number
DRAWING NUMBER A103	REV	