

PROPOSED SITE PLAN

PHASE 5, PARC GWERNEN, TYCROES

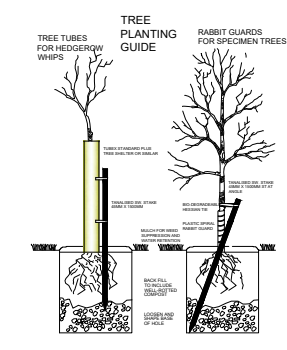
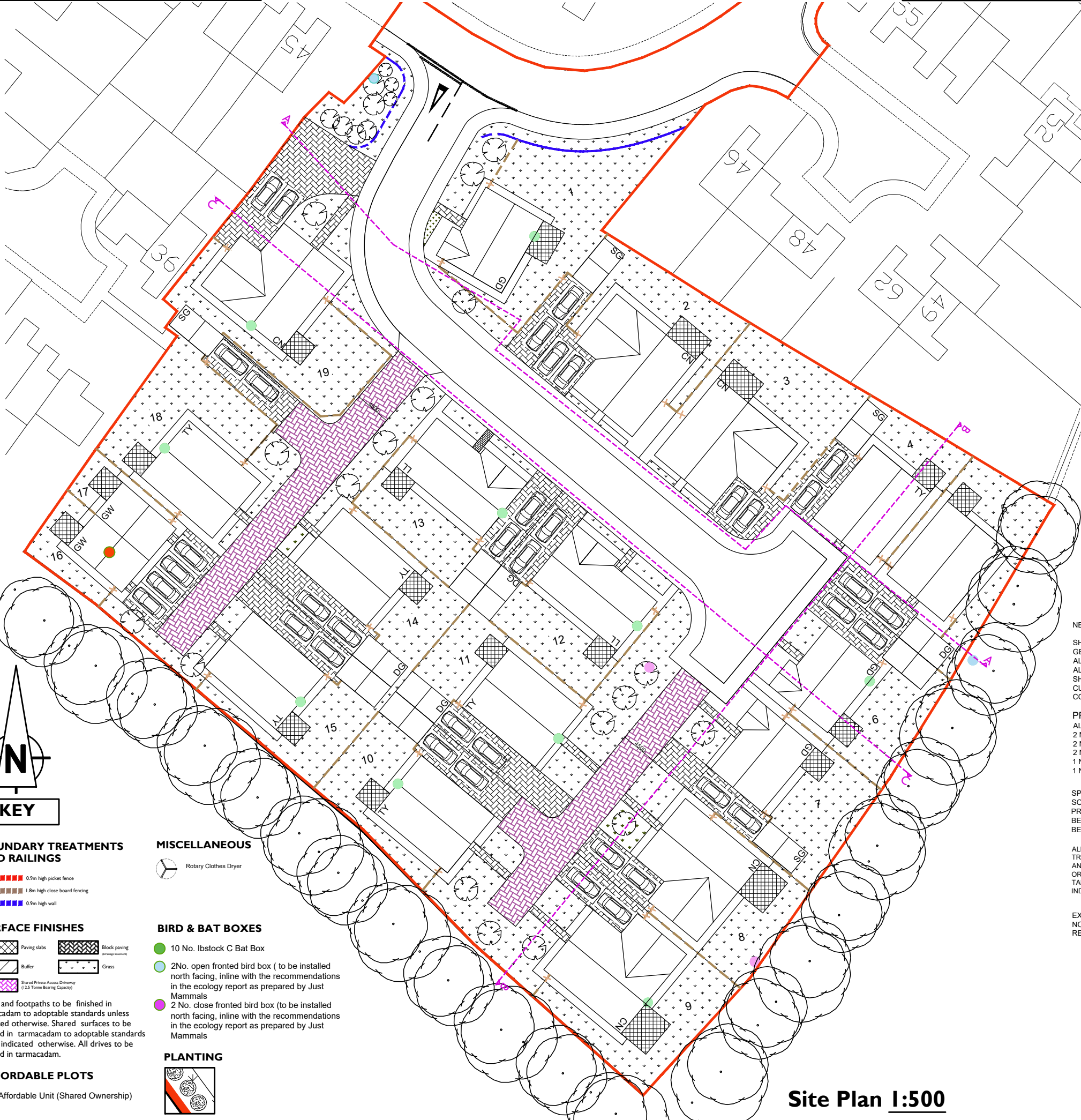

SCHEDULE OF LANDSCAPING DETAILS- (HARD LANDSCAPING)

SURFACE FINISHES :

DRIVEWAYS - 80MM MARSHALLS PRIORA PERMEABLE PAVING (CHARCOAL COLOUR), ON 38MM SHARP SAND, ON 400MM CONSOLIDATED THICKNESS OF OPEN GRADED SUB-BASE MATERIAL, ON ENGINEERING MEMBRANE

REAR GARDENS - LAID TO GRASS WITH PAVED PATIO (MARSHALLS PRIORA PERMEABLE PAVING)

ENCLOSURES/FENCING
REAR GARDENS: 1800MM HIGH VERTICAL TIMBER CLOSE BOARDED FENCE

TIMBER LEDGE AND BRACED SIDE GATES TO EACH HOUSE (AS APPROPRIATE) WITH 1800MM HIGH CLOSE BOARDED TIMBER SIDE FENCE PANEL.

PLANTING SEASON - RESTRICTED TO NOVEMBER-MARCH (INCLUSIVE)

TREE AND SHRUB PLANTING
TREES AND SHRUBS TO BE TO BS 3936:1992 NURSERY STOCK PART 1.

AREAS PROPOSED FOR PLANTING SHOULD HAVE TOPSOIL EITHER STRIPPED OR PROTECTED DURING THE CONSTRUCTION PERIOD.

LAWN AREAS
REMOVE ALL STONES, RUBBISH, PERNICIOUS WEEDS.
PROVIDE 200MM TOPSOIL TO BS 3882:1994 TO EXCAVATED AREAS ON COMPLETION AND LEAVE READY FOR SEEDING/TURFING ETC
ALL PLANTING, SEEDING AND TURFING IN THE APPROVED DETAILS OF LANDSCAPING SHALL BE CARRIED OUT IN THE FIRST PLANTING AND SEEDING SEASON FOLLOWING THE COMPLETION OF EACH DWELLING.

5 YEAR MAINTENANCE SCHEDULE

NEW SHRUB PLANTING :-

SHRUBS TO BE PLANTED IN GROUPS OF SIMILAR SPECIES WITH GENERALLY THE TALLER SPECIES PLANTED AT THE REAR OF BEDS. ALL SHRUBS TO COMPLY WITH B.S. 3936 PT. 1. 1992. ALL SHRUBS PLANTED TO ORIGINAL NURSERY DEPTH. SHRUB BEDS TO BE FREE OF STONES, WEEDS, ETC. AND CULTIVATED TO A MINIMUM DEPTH OF 300MM. ALL BEDS TO BE COVERED WITH BARK MULCH TO THE APPROPRIATE DEPTH.

PRINCIPAL SHRUB BEDS RETAINED AS PRIVATE

ALL PLOTS
2 No. BERBERIS THUNBERGII "ROSE GLOW" 3L 30-40cm
2 No. CISTUS "SILVER PINK" 3L 30-40cm
2 No. WEIGELA FLORIDA "FOLIIS PURPUREIS" 3L 40-60cm
1 No. POTENTILLA FRUTICOSA "ELIZABETH" 10L 40-60cm
1 No. VIBURNUM DAVIDII 3L 30-40CM

SPECIMEN TREES

SORBUS ARIA 'LUTESCENS'	250-3500CM	14-16CM	BARE ROOT
PRUNUS AVIUM	250-3500CM	14-16CM	BARE ROOT
BETULA UTILIS JACQUEMONTII	250-3500CM	10-12CM	BARE ROOT
BETULA PUBESCENS	250-3500CM	10-12CM	BARE ROOT

ALL EXISTING HEDGEROW TREES ARE TO BE RETAINED AND MANAGED. NO EXCAVATION OR CONSTRUCTION WORKS TAKING PLACE WITHIN ANY INDIVIDUAL RPA

EXISTING MATURE HEDGEROW NOT AFFECTED BY WORKS - RETAINED AND LIGHTLY MANAGED

HOUSE TYPES	PLOT NUMBERS
Cennen 3 Units 126m ²	2,3,8,9 & 19
Gwendraeth 1 Unit 154m ²	1,6 & 7
Gwy 2 Units 76m ²	16 & 17
Tywi 7 Units 95m ²	4, 5, 10, 11, 14, 15 & 18
Lliedi 2 Units 103m ²	12 & 13
Single Garage 4 Units 18m ²	1, 4, 7 & 18
Double Garage 4 Units 36m ²	5-6, 10-11, 12-13 & 14-15
TOTAL	19 Units

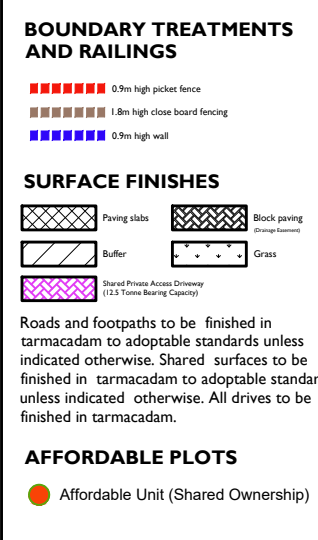
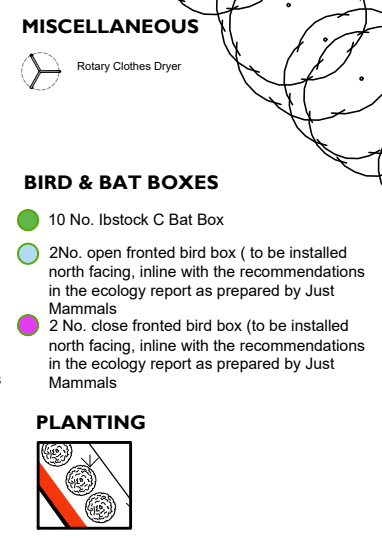
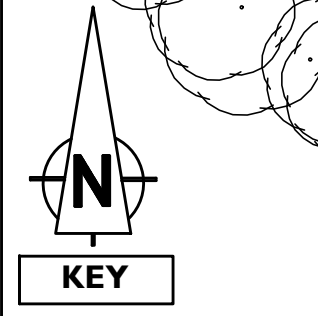

Notes

This drawing is copyrighted and must not be reproduced or disclosed to third parties without the prior written permission of Prime Architecture Limited.

Do not scale from this drawing. Responsibility will not be accepted by Prime Architecture Limited for errors made by others scaling from the drawing. Use written dimensions only. Contractor to verify all dimensions before commencing work on site.

Prime Architecture Limited are to be notified immediately in writing of any discrepancies. All survey information incorporated within the drawings cannot be guaranteed as accurate unless confirmed by a fixed dimension.

All dimensions are in millimeters unless otherwise noted.

This drawing is to be read in conjunction with all relevant project drawings and specification prepared by Prime Architecture Limited and other relevant consultants, specialists, etc.

CDM noted are provided to assist the contractor in managing residual hazards identified during the design stage. Any such notes do not relieve the contractor of their duties and they must provide a safe system of work based on method statements, risk assessments, etc.

Revision:	Description:	Date:
A	New site design	02.10.2018
B	Change of house type to plots 2 & 3	01.12.2018
C	Change of handing to plots 2 & 3	03.12.2018

Drawing Status:

PLANNING



Prime Architecture Limited, 3 Llandeilo Road, Cross Hands, Llanelli, SA14 6NA

01269 842 575

info@prime-arch.co.uk

www.prime-arch.co.uk

© Prime Architecture Limited

Client:

Haywood Homes Ltd

Project Title:

Phase 5 - Development of 19 New Homes at Parc Gwernen, Tycroes

Drawing Title:

Proposed Site Plan

Scale:

1:500 @ A3

Date:

November 2018

Job No:

617

Drawing No:

01

Rev:

C

Site Plan 1:500