

**ACCESS ROAD CONSTRUCTION- PAVIOURS**  
**(SUITABLE FOR LIGHT GOODS VEHICLES)**

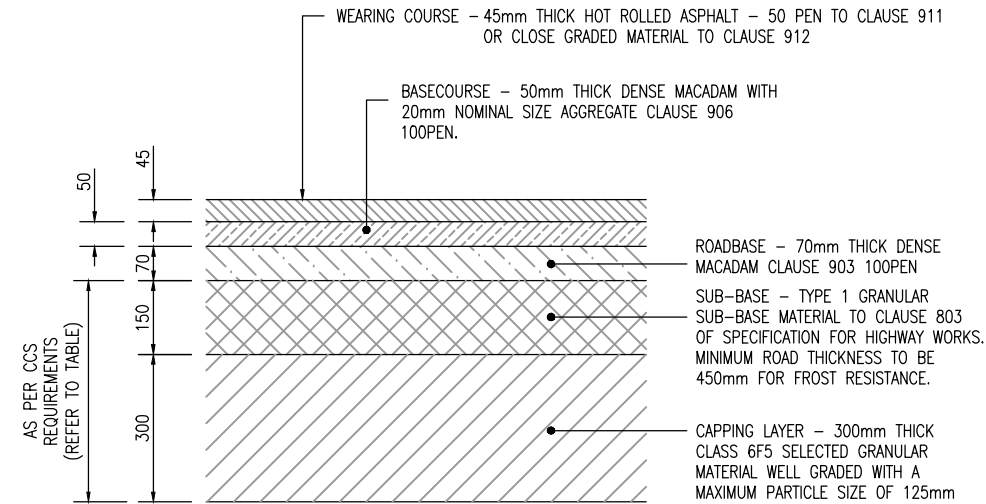

**ACCESS ROAD CONSTRUCTION- TARMAC**  
**(SUITABLE FOR LIGHT GOODS VEHICLES)**

**NOTES**

1. GROUND INVESTIGATION REPORT JOB NO: X23554 RECOMMENDS A CBR VALUE OF 2% TO BE USED FOR PRELIMINARY DESIGN PURPOSES.
2. ALL ENGINEERED FILL MATERIALS SHOULD BE COMPACTED IN LAYERS AS PER THE REQUIREMENTS OF THE SPECIFICATION FOR HIGHWAY WORKS.
3. IN-SITU CBR TESTS TO BE CARRIED OUT AT FORMATION LEVEL. REFER TO TABLE:

**SUB-BASE/CAPPING REQUIREMENTS**

CBR VALUE	SUBBASE	CAPPING LAYER
[%]	[mm]	[mm]
>15	150	-
5<CBR<15	225	-
2<CBR<5	150	300
1<CBR<2	150	450
CBR<1	150	600

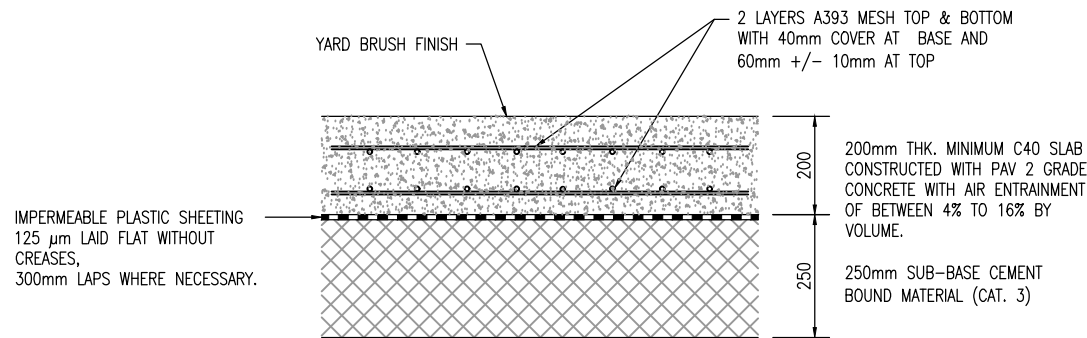

**INDUSTRIAL YARD CONCRETE CONSTRUCTION**  
**(SUITABLE FOR HEAVY GOODS VEHICLES)**

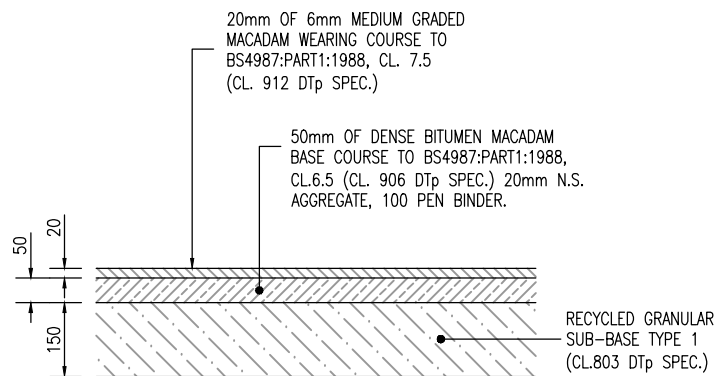

**FOOTWAY CONSTRUCTION- TARMAC**

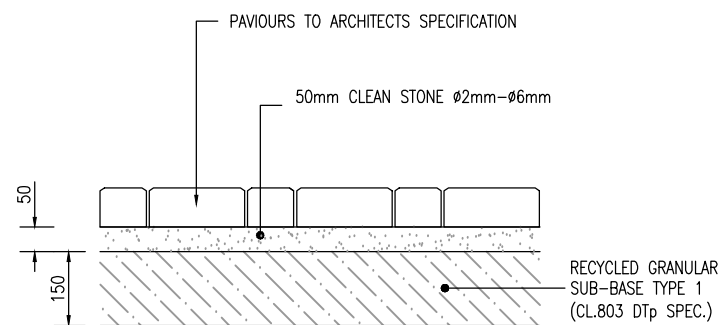

**FOOTWAY CONSTRUCTION- PAVIOURS**

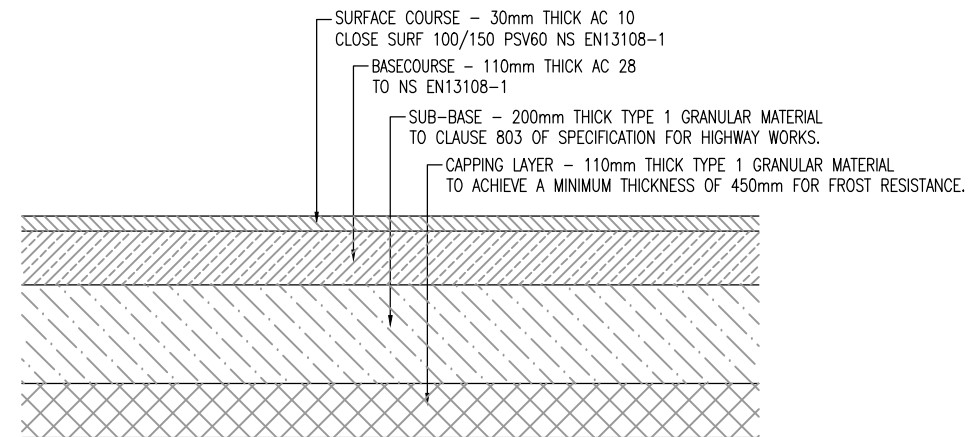

**PARKING BAY CONSTRUCTION**

- GENERAL NOTES**
1. DO NOT SCALE THIS DRAWING.
  2. CONTRACTOR TO CHECK ALL DIMENSIONS AND REPORT ALL ERRORS AND OMISSIONS TO THE ENGINEER.
  3. ANY DISCREPANCY TO BE REPORTED IMMEDIATELY TO THE ENGINEER.
  4. THIS DRAWING TO BE READ IN CONJUNCTION WITH ALL RELEVANT ARCHITECTS, SUBCONTRACTORS AND SPECIALISTS DRAWINGS AND SPECIFICATIONS.

Rev.	Detail	By	Date
------	--------	----	------

**Revisions**

Reinforcement schedules nos.



Structural & Civil Engineering Consultants

First Floor  
7 St James Crescent  
Swansea  
SA1 6DP

Telephone +44 1792 473 182  
e-mail admin@cb3consult.co.uk  
web www.cb3consult.co.uk

Client

**MOLLER PCI**

Project

**PROPOSED NEW HEADQUARTERS  
MOLLER PCI, GARNGOCH  
SWANSEA**

Drawing Title

**HIGHWAY STANDARD  
DETAILS**

**PLANNING**

Project No. <b>C0947</b>	Drawing No. <b>C-005</b>
-----------------------------	-----------------------------

Scales N.T.S	Date 17.11.17	Revision -
Drawn JP	Checked GT	Sheet Size A3