

DO NOT SCALE

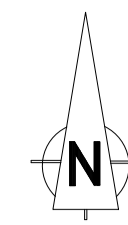

NOTES:

THE PROPERTY OF THIS DRAWING AND DESIGN IS VESTED IN ROGER CASEY ASSOCIATES AND MUST NOT BE COPIED OR REPRODUCED IN ANY WAY WITHOUT THE WRITTEN CONSENT OF ROGER CASEY ASSOCIATES.

THE CONTRACTOR IS TO CHECK ALL LEVELS AND DIMENSIONS BEFORE WORK COMMENCES, AND ANY DISCREPANCIES TO BE REPORTED IMMEDIATELY TO THE CONSULTANTS.

WORK TO FIGURED DIMENSIONS IN PREFERENCE TO SCALING.

THIS DRAWING IS TO BE READ IN CONJUNCTION WITH ALL OTHER ROGER CASEY ASSOCIATES DRAWINGS AND SPECIFICATIONS AND ALL OTHER CONSULTANTS DRAWINGS AND SPECIFICATIONS RELATING TO THIS PROJECT.

VEHICLE TRACKING LEGEND

- BODY OUTLINES ENVELOPE (FORWARD) ———
- CHASSIS OUTLINES ENVELOPE (FORWARD) ———
- BODY OUTLINES ENVELOPE (REVERSE) - - - - -
- CHASSIS OUTLINES ENVELOPE (REVERSE) - - - - -

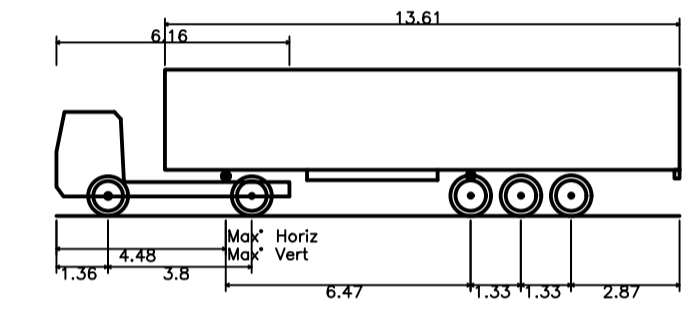

FTA Design Articulated Vehicle (1998)	16.480m
Overall Length	2.550m
Overall Width	3.870m
Min Body Ground Clearance	0.515m
Max Track Width	4.470m
Lock to lock time	3.00s
Kerb to Kerb Turning Radius	6.550m

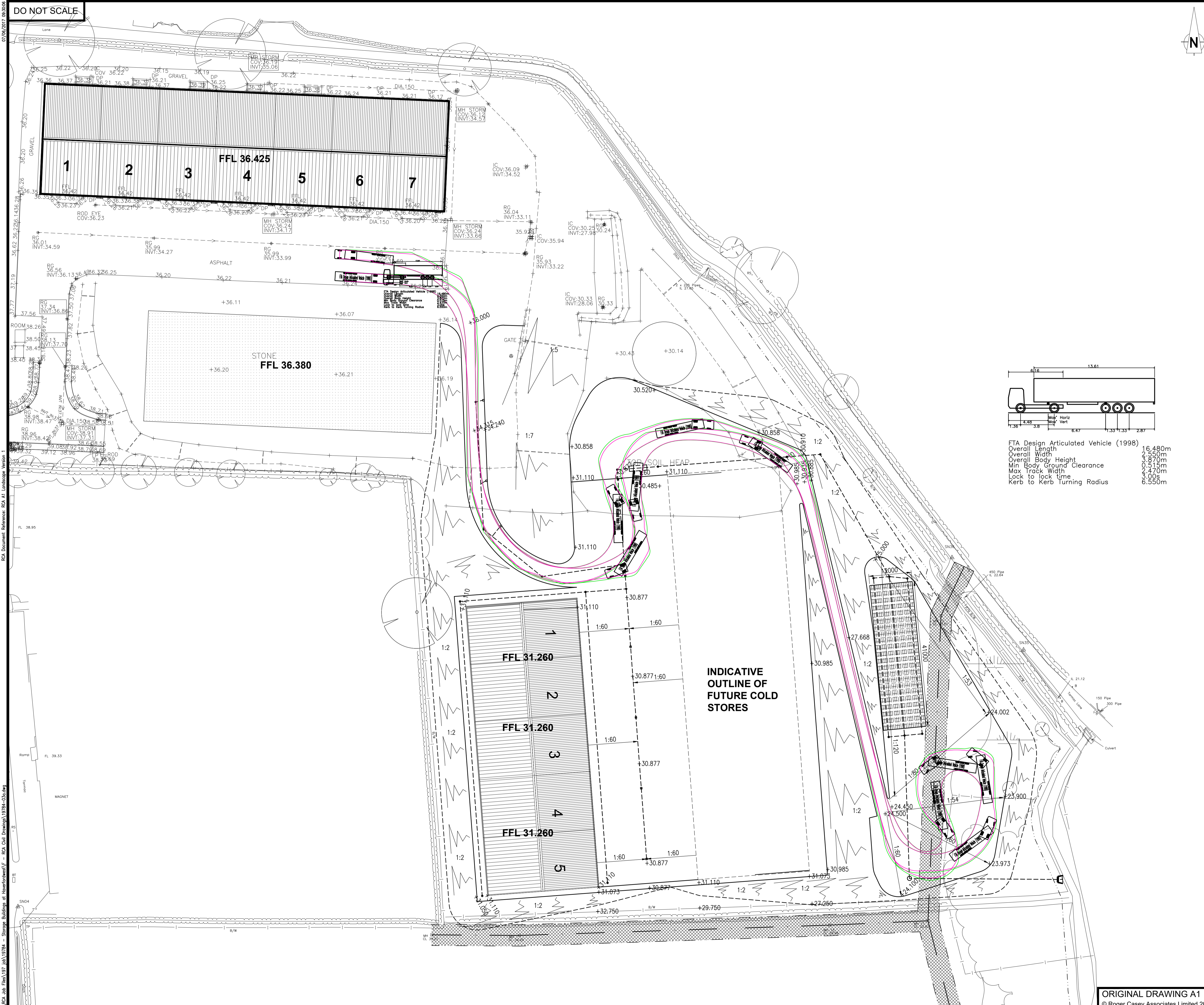

REV	DESCRIPTION	DRAWN	CHECK	DATE
A	7 BAY COLD STORE OUTLINED, STATUS CHANGE TO PLANNING	GWP	RSC	01/06/17

DRAWING STATUS: PLANNING



Roger Casey Associates
Consulting Civil & Structural Engineers

Ty Mansel, 6 Mansel Street,
Carmarthen,
Carmarthenshire SA31 1PX
T: 01267 222 646
Units 10 & 11, Merlin's Court,
Winch Lane, Haverfordwest,
Pembrokeshire SA61 1SB
T: 01437 762 795
E: office@rca-eng.co.uk
W: www.rca-eng.co.uk

CLIENT:
PUFFIN PRODUCE LTD 

PROJECT:
PUFFIN PRODUCE
WITHYBUSH INDUSTRIAL ESTATE
HAVERFORDWEST, PEMBS.

DRAWING TITLE:
AUTOTRACK PLAN THROUGH
SITE

DRAWN BY: GWP	DESIGN BY: GWP	CHECKED BY: RSC	DATE: 16/05/17
SCALES: 1:500	DRAWING No: 19784/06	REVISION: A	

ORIGINAL DRAWING A1
© Roger Casey Associates Limited 2016

R:\RCA_sbs_files\19784\19784_A1_Landscape_V1.dwg - 19784 - Storage Buildings at Haverfordwest V1 - RCA Civil Drawings\19784-005.dwg